

---

# Rusk County Forestry Department

311 Miner Ave. E. Suite 115  
Ladysmith, WI 54848  
Office: (715) 532-2113



## RUSK COUNTY LAND AND FORESTRY COMMITTEE

**DATE: TUESDAY, NOVEMBER 19, 2024**

**PLACE: RUSK COUNTY GOVERNMENT CENTER MEETING ROOM**

**TIME: 3:00 PM**

### CALL TO ORDER

### ELECTION OF VICE-CHAIR

**APPROVAL OF MINUTES** – October 15, 2024

**PUBLIC COMMENT** – limit of 3 minutes per person

### MONTHLY REPORTS

1. Parks and Recreation Report
2. Timber Sales Report
3. Administrator's Report
4. Public Trail Committee Report

### DISCUSSION AND POSSIBLE MOTION

1. Trail Recommendations
2. Award Fall 2024 Timber Sale Bids
3. Award Weirgor ATV Trail Bids – Winter Hauling and Spreading Gravel
4. Access Permit
5. Campground Budget update
6. Historic CC Camp Signage – ATV Trail
7. Excelsior Road Winter Use
8. Forestry Truck Radio Request
9. Accept the 2025 Work Plan and forward to the County Board
10. Rocky Mountain Elk Foundation Grant Approval
11. Timber Sale Prospectus review
12. Habitat non-lapsing account request
13. **Closed Session** – Announced by Chair

Timber Sale Contract Extensions pursuant to WI Stats 19.85(1)(e). Chair announces a closed session for deliberating or negotiating the purchasing of public properties, the investing of public funds, or conducting other specified public business, whenever competitive or bargaining reasons require a closed session.

**Open Session** – Possible Motion on Topic of Closed Session.

14. Out of County Travel
15. Review and Approve Bills
16. Set the Next Meeting Date
17. Adjourn

*Requests from persons with disabilities who need assistance to participate in this meeting should be made to the County Clerk's Office at 715-532-2100 with as much advance notice as possible. At any time, a quorum of a County Committee or of the County Board may be present at the meeting to observe the proceedings, but no action will be taken except by those Committee Members for the stated Committee meeting and only on noticed agenda items.*

# Rusk County Land and Forestry Committee

## Meeting Minutes

### October 15, 2024

---

**Land and Forestry Committee Present:** P. Schneider, P. Unterschuetz, J. Biller  
Excused: A. Hampton

**Others Present:** J. Macholl, M. Zimmer, H. Woldhuis, D. Jochimsen, B. Grunseth, G. Sihsmann, R. Ellwanger, D. Mansky, J. Waeltz

#### **CALL TO ORDER**

The monthly meeting of the Rusk County Land and Forestry Committee was called to order at 3:00 p.m. on Tuesday, October 15<sup>th</sup>, 2024.

#### **APPROVAL OF MINUTES:**

*Motion by Biller, and second by Schneider to approve the August 20, 2024 meeting minutes as presented. Motion carried*

#### **PUBLIC COMMENT:**

Public spoke on Leaf it to Rusk ATV Rides updates. CC Camp update request. ATV Access sign update request regarding yellow signs.

#### **MONTHLY REPORTS**

##### Parks and Recreation Report:

Mike reported: The water has been turned off at the campgrounds. ATV pavilion – looking into signage options for old CC Camp. Camping has slowed down regarding reservations. Highway dept to assist with dock removal next week. ORV/snowmobile council meetings – funding reduction, less projects being funded. Waiting on permits for Bucks ATV trail project, waiting on wetland delineation report to move forward. Weirgor ATV trail nearly completed, gravel on north end will receive more gravel.

##### Timber Sale Report:

Jerrad reported: Several crews working, wood from last winter moving, closing out sales. Klein, CFP, Hoyt, Wojcik, RM Bay, Kreier Forest Products, J&J Enterprise are all actively working on sales.

##### Administrator Report:

Jerrad reported: The sustainable forest grant for Jew Creek road work was not awarded. Received restitution on B.R. case. ORV/Snowmobile council meeting – general disappointment over lack of funding. Attended partnership meeting with DNR staff regarding DNR county forest hours. Forestry Technician position came open, interviews were held today. WCFA Fall Meeting – Co Forest Administrator Grant may see an increase, request to increase DNR partnership hours, lots of discussion on infrastructure improvements. ANEW visit to the County – interviewed County Forest Administrator and toured areas of the Blue Hills.

##### Ad-Hoc Public Trail Committee Report:

The trail committee reported: Trail inspections, BH-1234 needs a gate, request for signs for white diamond trail ends, but ATVs may continue. Committee members installing signs.

#### **DISCUSSION AND POSSIBLE MOTION**

Rusk County Land and Forestry Committee  
Meeting Minutes  
October 15, 2024

---

Trail Recommendations:

Portions of BH-1194 and BH 1199 request to change from ATV/UTV to Highway Use. The spur to the east toward the funded ATV trail will remain as ATV/UTV access only while the horse shoe to the south will be open to highway licensed vehicles.

*Motion by Schneider, second by Biller to approve trails presented. Motion Carried.*

ATV Pavilion:

Reviewed photos of pavilion construction progress and completion.

Campground Online Reservation Update Expense Request:

Request to spend \$3050.00 to update campground reservation site.

Request to request \$1975.00 from tourism for update to campground reservation site in regards to marketing tools.

*Motion by Schneider, second by Biller to approve \$1975+ potential \$1500 to joint tourism, and \$3050 from parks budget for updates as requested. Motion Carried.*

Rocky Mountain Elk Foundation Grant Approval:

Request to invest \$2,000 of habitat funding towards Elk Foundation grant to receive \$8,000 of improvements to access on the requested wood road.

*Motion by Schneider, second by Biller, to apply and accept rocky mountain foundation grant and commitment of \$2,000 of Habitat funding towards DNR Rocky Mountain Elk Foundation Grant pending there will be no new restrictions on County Forest lands due to the grant. Motion Carried.*

Timber Sale Prospectus:

Presented prospectus

Request to edit IX #6 to add 6" of snow coverage.

*Motion by Biller to accept with edits. Motion failed due to lack of a second.*

*Motion by Schneider, second by Biller, to accept as presented and review potential edits in November for future prospectus. Motion Carried.*

Advertise for Timber Sale:

Reviewed advertisement for Timber Sales.

*Motion by Biller, second by Schneider, to advertise for Fall 2024 Timber Sales. Motion Carried.*

Forestry Fee Schedule:

Presented updated fee schedule.

Firewood permit \$25/10 cord

Dispersed Camping permit \$25/14 days

Dump Station add \$15 for use without a campsite reservation/purchase

Printing fees

Rusk County Land and Forestry Committee  
Meeting Minutes  
October 15, 2024

---

Color Prints 8.5x11 - \$0.25	Plotter up to 48" - \$25.00
Color Prints 8.5x14, 11x17 - \$1	Plotter up to 60" - \$30.00
BW Prints 8.5x11 - \$0.15	Plotter up to 72" - \$35.00
BW Prints 8.5x14, 11x17 - \$0.50	

*Motion by Schneider, second by Biller, to approve as presented except for reclamation fee. Motion Carried.*

Clubhouse Rental:

Request from Deertail 4-H club for October 12<sup>th</sup> hayride and potluck event.

*Motion by Schneider, second by Biller, to approve and waive rental fees. Motion Carried.*

2025 Budget Review:

Substantial cuts to the budget since last reviews.

\$19,000 removed from parks budget

\$16,800 removed from forestry budget

Out-of-County Travel:

Elk Advisory Committee Meeting

ORV/Snowmobile Council

*Motion by Schneider, second by Biller to approve out-of-county travel as presented. Motion Carried.*

Review and Approve Bills:

*Motion by Biller, second by Schneider, to approve the August and September AP report as presented. Motion carried.*

**ANNOUNCEMENTS**

Unterschuetz is willing to give a tour of papermill to any committee members and forestry staff members who would like to attend.

**ADJOURNMENT**

The meeting adjourned at 4:24 p.m.

The next meeting will be on Tuesday, November 19, 2024, at 3:00 p.m. in the County Board Room.

*Minutes prepared by:  
Heidi Woldhuis, Forestry Department Office Manager*

# Private Access Permit Kurt Brown NE, SW, S14, T36N, R8W

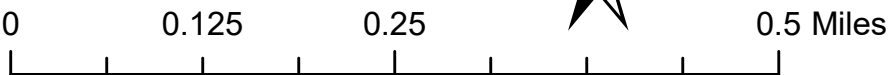

\*This map is not a survey of the actual boundary of any property this map depicts.

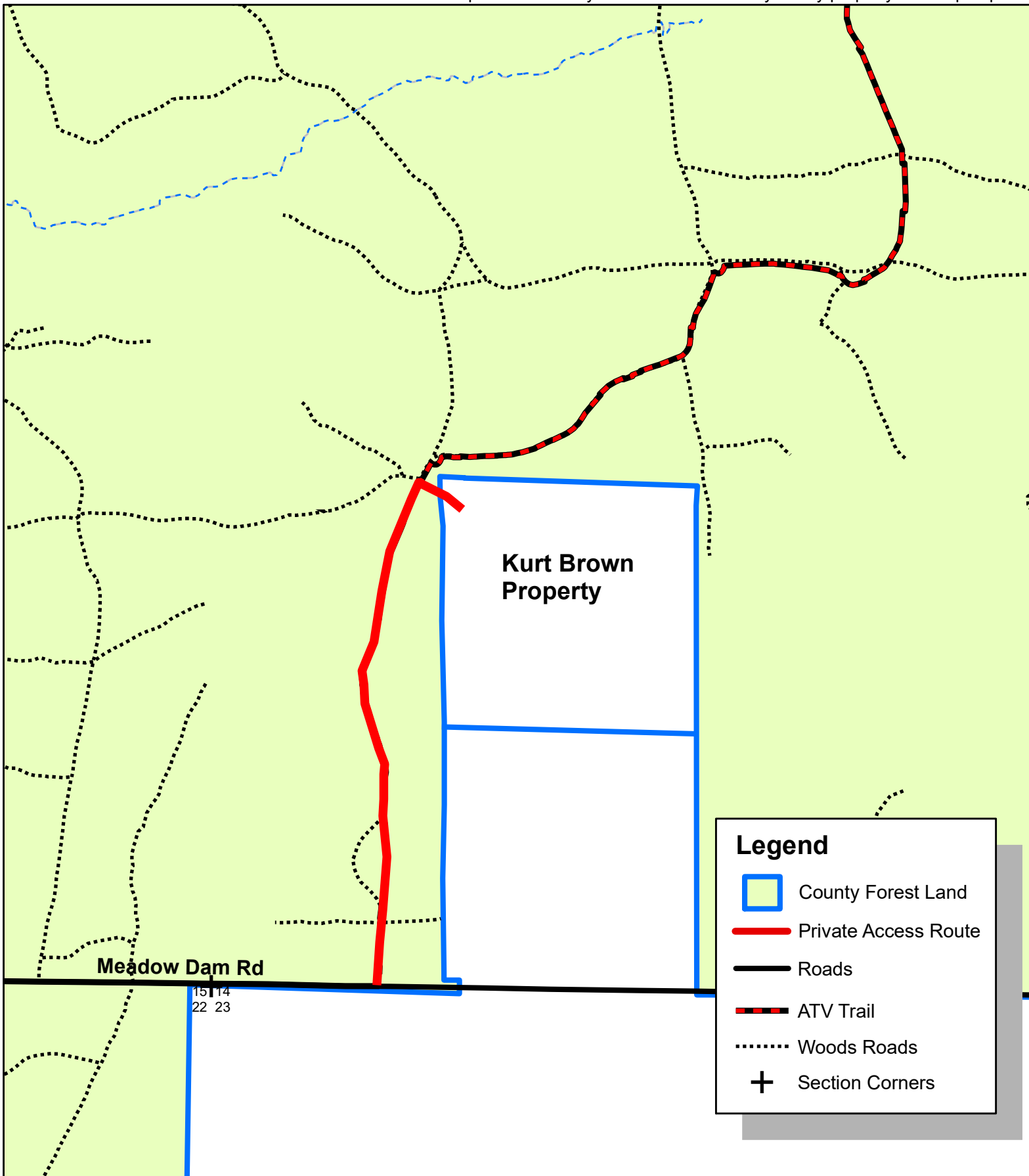

**Legend**

- County Forest Land
- Private Access Route
- Roads
- ATV Trail
- Woods Roads
- Section Corners

CAMPGROUND/PARK	2019	2020	2021	2022	2023	2024
Parks & Rec Campground Fees	\$ 43,582.04	\$ 74,066.49	\$ 89,349.37	\$ 85,684.92	\$ 92,500.52	\$ 86,108.78
Parks & Rec Insurance Recovery			\$ 17,200.00			
Parks & Rec Powerline Funds			\$ 25,000.00			
Transfer from Habitat Funds	\$ 2,500.00	\$ 2,496.00	\$ 1,559.68			
Total Revenue	\$ 46,082.04	\$ 76,562.49	\$ 133,109.05	\$ 85,684.92	\$ 92,500.52	\$ 86,108.78
PARKS & REC-PARKS MANAGER	\$ 59,038.35	\$ 59,875.92	\$ 53,994.88	\$ 65,443.05	\$ 69,157.98	\$ 57,034.31
PARKS & REC-EXTRA HELP	\$ 13,600.00	\$ 5,697.21	\$ 5,112.50	\$ 22,647.50	\$ 21,238.75	\$ 22,554.00
PARKS & REC-TECH 50%	\$ 652.60	\$ 2,005.19	\$ 5,463.50	\$ 3,258.50	\$ 1,971.44	\$ 9,609.75
PARKS & REC-TECH 50%	\$ 23,543.80	\$ 20,645.04	\$ 21,818.88	\$ 21,158.40	\$ 5,999.15	
PARKS & REC-SOC SECURITY	\$ 6,936.05	\$ 6,369.68	\$ 6,283.99	\$ 8,246.54	\$ 6,924.56	\$ 6,338.80
PARKS & REC-RETIREMENT	\$ 5,457.97	\$ 5,605.76	\$ 5,481.51	\$ 5,854.53	\$ 5,247.85	\$ 4,598.43
PARKS & REC-HEALTH INSURANCE	\$ 33,298.64	\$ 38,001.10	\$ 31,010.05	\$ 31,465.08	\$ 23,233.84	\$ 18,152.88
PARKS & REC-WORKMAN'S COMP	\$ 3,281.34	\$ 2,643.85	\$ 1,400.05	\$ 1,685.21	\$ 2,492.00	
PARKS & REC-CONTRACTED SERVICE	\$ 73.62	\$ 4,332.30	\$ 3,322.34	\$ 7,688.46	\$ 8,619.97	\$ 6,293.49
PARKS - COMMUNICATIONS	\$ 2,692.17	\$ 89.94	\$ 335.06	\$ 365.52	\$ 402.00	\$ 320.22
PARKS & REC - UTILITIES	\$ 187.88	\$ 8,275.67	\$ 11,503.48	\$ 10,405.33	\$ 7,899.12	\$ 5,036.42
PARKS&REC-INSURANCE CLAIM(E)	\$ 7,299.38		\$ 22,200.00			
PARKS & REC-MAINTENANCE	\$ 14,931.07	\$ 2,273.15	\$ 12,615.86	\$ 20,707.93	\$ 12,587.97	\$ 11,033.94
PARKS & REC-POINT & PAY FEES	\$ 200.64	\$ 1,210.00	\$ 1,521.00	\$ 1,522.50	\$ 2,841.75	\$ 1,404.40
PARKS- CENTRAL DUPLICATING	\$ 516.23	\$ 204.30	\$ 216.41	\$ 254.23	\$ 272.74	\$ 109.26
PARKS-OFFICE SUPPLIES	\$ 2,827.73		\$ 232.07	\$ 461.47		
PARKS & REC-TRAVEL EXPENSES	\$ 2,699.71	\$ 1,399.45	\$ 8,144.28	\$ 11,688.36	\$ 13,667.70	\$ 6,494.98
PARKS & REC-WORKING SUPPLIES	\$ 209.79	\$ 208.37	\$ 536.28	\$ 2,531.14	\$ 1,638.33	\$ 958.31
PARKS & REC-REA BT LDGS MTNC	\$ 2,284.77	\$ 1,366.10	\$ 338.17	\$ 235.42	\$ 815.99	\$ 1,405.53
PARKS & REC-LEASED EQUIPMENT	\$ 1,624.52		\$ 836.52	\$ 724.52	\$ 497.43	\$ 248.00
PARKS & REC-EQUIPMENT	\$ 33,550.00		\$ 1,699.99			
PARKS-TRANS PARKS PATROL	\$ 7,401.48		\$ (8,627.30)	\$ 605.70		
Total Expenses	\$ 222,307.74	\$ 160,203.03	\$ 185,439.52	\$ 216,949.39	\$ 185,508.57	\$ 151,592.72





(773 words)

## THE CIVILIAN CONSERVATION CORPS

Well known as the CCCs the Civilian Conservation Corps was formed by the government in 1933 as an organization to help the youth of America. The object was to provide employment for young men who could not get jobs in the regular work force. It not only gave them employment and an opportunity to help their destitute families but gave them pride and confidence in themselves.

The young men reported to camp similar to an army recruit. They slept in a barracks and ate their meals in a mess hall. Discipline was very much like the regular army.

Pay for the CCC recruit, was about \$30.00 per month. He was given \$5.00 for himself and the balance was sent home to help support his parents and siblings to survive the depression. The \$5.00 does not sound like much but it was more than enough to cover his meager needs. Everything he needed to survive was furnished for him including better food than he had probably ever eaten.

The CCCs performed many duties for the good of the country. In the east and larger cities many of the jobs were clerical. These works included alphabetizing and indexing official records. They transferred many of the Federal census to micro-film and numerous other services of this type.

The rural area jobs were different in nature but every bit as important. These eager young men dug many ditches, helped build roads and bridges and planted thousands of acres of cut over burned over lands to trees. The majority of these men were city boys, many of them teenagers. The only requirement was they must be of good character. It must have been quite a shock for these young men to arrive at their destination by train to be taken to a camp in the woods where they would live and work.

The Conservation Department fire protection system was developed at this time. Fire towers were built on high peaks in strategic areas. A telephone line was erected from the towers to the Ranger station in Ladysmith. This allowed a fire warden to report a suspicious smoke immediately and have a fire fighting crew on scene before the fire got out of hand. For years fires had ravaged the treeless cutover lands. This kept down the growth of new forests. The CCC Boys helped get this operation up and running. One gentleman named Thaddeus tells of his time in the CCCs as a greenhorn kid from Chicago. When they called for volunteers to paint the fire tower north of Glen Flora he raised his hand. He even produced a picture of himself atop the tower. Speaking of it now he shakes his head as if wondering what in the world he had been thinking of.

Talking to these same young men today of their experiences in the CCC it surprising to note many of them remember it as the best thing that ever happened to them. The manual labor and discipline really made men of them and they often speak fondly of those times.

Many camps were built in Wisconsin for the CCC. The first camp site in Rusk County was approved in the spring of 1933 in section 17 in the west part of the Town of Murry. Tree clearing began there around a large spring that was to be their only source of water. For some unknown reason the site plans changed and two weeks later clearing was begun at Meadow Dam, also in Murry.

Several buildings were erected to house administration, officer quarters and mess hall. The recruits themselves lived in tents or rather teepees.

This Camp Rusk operated from June until November when more changes were made. The decision had been made to move the camp to north of Glen Flora along the Flambeau River. It could have been made because of health and safety conditions as the land at Meadow Dam was low and flat and prone

to flooding. The new camp Rusk was a beautiful encampment with many permanent and well tended buildings. Crews that worked to far from camp to return at night camped out sometimes for weeks at the job site.

As the depression loosened its' hold on the country more jobs became available in the civilian world. Many young men were drafted into the army and as World War II approached many enlisted to fight for their country. The need for the CCCs was no longer so great.

In 1942 the CCCs were disbanded and Camp Rusk was closed. Gradually the buildings were sold off and moved and today the wilderness has reclaimed the site.

(173 words)

**Civilian Conservation Corps (CCC)**, a public works program established by the U.S. government in 1933 to address the high unemployment rate during the Great Depression. The CCC aimed to provide jobs, self-reliance, and a sense of purpose to unemployed youth by engaging them in various conservation and infrastructure projects. The work done by CCC members was diverse. The men worked on physical projects, including digging ditches, building roads and bridges, and planting trees on deforested land. These efforts contributed significantly to environmental restoration and infrastructure development. The CCC played a crucial role in developing the fire protection system for the Conservation Department. They built fire towers and communication lines, improving early detection and response to forest fires.

**Camp Rusk**, which housed CCC recruits underwent several relocations and operational changes. Initially located in Murry, it was moved to a more favorable site near Glen Flora along the Flambeau River. The camp operated from 1933 until 1942, when the need for CCC work diminished as the economy recovered and the U.S. entered World War II.

(146 words)

The **Civilian Conservation Corps (CCC)** was a U.S. public works program established in 1933 to combat high unemployment during the Great Depression. Its primary goal was to provide jobs and foster self-reliance among unemployed young men by involving them in various conservation and infrastructure projects. CCC workers participated in tasks like digging ditches, building roads and bridges, and planting trees on deforested land, which contributed to environmental restoration and infrastructure development. The CCC also played a key role in improving fire protection by constructing fire towers and communication lines for better forest fire detection and response.

**Camp Rusk**, which housed CCC recruits, was initially located in Murry but was later relocated to a site near Glen Flora along the Flambeau River. The camp operated from 1933 until 1942, when the need for CCC work declined as the economy improved and the U.S. entered World War II.

# Quotation

Mike's Repair & 2 Way Services  
 N2205 Stella Lane  
 Conrath, WI 54731  
 USA

Quote Number:  
 101

Quote Date:  
 Oct 23, 2024

Page:  
 1

**Quoted to:**

Rusk County Forestry Department  
 311 Miner Avenue East  
 Ladysmith, WI 54848

Customer ID	Good Thru	Payment Terms	Sales Rep
501	11/22/24	Net 30 Days	

Quantity	Item	Description	Unit Price	Extension
8.00	TM840 Kirisun Mobile	40 Watts DMR/FM Mobile	642.00	5,136.00
8.00	RENT 1	Tower Rent Per Raido Per Month is \$13.00 Is Billed By The Quarter	13.00	104.00
			<b>Subtotal</b>	5,240.00
			<b>Sales Tax</b>	288.20
			<b>Total</b>	5,528.20

<h1>Rassbach</h1> <h2>Communications</h2> <p>FreedomLINK</p>	405 N. Hastings Place Eau Claire, WI 54703 Phone: 715.832.6763 Fax: 715.832.1698	FO#  PO#
--	---	----------------

<b>Heidi Woldhuis</b> Rusk County Forestry Office Manager 311 Miner Ave. E Suite 115 Ladysmith, WI 54848	Phone: (715) 532-2113 Fax: Email: hwoldhuis@ruskcountywi.us Customer: 10011 County: Rusk	Date: 10-3-2024 Order Date: Rep.: Bryan Rassbach
--	--	--

Qty	Name	Price	Total
3	FreedomLINK Airtime/Month	\$17.92	\$53.76
3	Hytera HM682 Mobile, UHF, 45 Watts, DMR, Color Display, 3-Year Warranty	\$548.31	\$1,644.93
3	Hytera Ign. Sense Cable	\$39.00	\$117.00
3	Programming to Customer Frequencies	\$.00	\$.00
3	UHF Antenna Kit with BNC Connector	\$27.50	\$82.50
		Sub Total	\$1,898.19
		Shipping & Handling	\$25.00
		Taxes	\$0.00
		<b>TOTAL</b>	<b>\$1,923.19</b>

<b>Comments:</b> Pricing valid for 15 days Net 15 FCC requires an FCC License for radio use Match to existing MD612 Customer Canceled orders are subject to 20% restocking fee	<b>Office Use Only:</b> Add on/FTU/New Market Method: RCS-FL to D/S/C/I
---	--

*Thank you for your business.*

# 2025 ANNUAL WORK PLAN



## RUSK COUNTY FORESTRY DEPARTMENT

### GOVERNING COMMITTEE

#### LAND AND FORESTRY

Philip Unterschuetz– Chairman

Phil Schneider

Jerry Biller

Alec Hampton

Kathy Halbur

### FORESTRY DEPARTMENT

Jerrad Macholl-Administrator

Dane Gravesen-Assistant Administrator

Mike Zimmer-Parks Manager

Roy Zubrod -Forester

Jake Moore – Forester

Jon Smith– Forest Technician

Heidi Woldhuis-Office Manager

### WI-DNR LIAISON FORESTER

Derek Jochimsen

Following is the annual Rusk County Forest work plan for the calendar year 2025. The plan gives direction and meaning to the proposed County Forest budget, further defines and supplements the County Forest Comprehensive Land Use Plan, and emphasizes the current needs of the County Forest program. This plan is needed to comply with Wis. Statute 28.11(5) and Chapter NR47.75 of the Wisconsin Administrative Rules for the administration of the County Forest Administrator Grant program.

## **REFERENCES**

1. Annual Integrated Planning Meeting held on October 2, 2024
2. Rusk County Forest Comprehensive Land Use Plan (2021-2035)





## **THE RUSK COUNTY FOREST MISSION STATEMENT**

Natural resources, such as those provided by the Rusk County Forest (RCF), are the base for addressing the ecological and socioeconomic needs of society. The mission of the Rusk County Forest is to manage, conserve, and protect these resources on a sustainable basis for present and future generations.

RCF resources should be protected from natural catastrophes such as fire, insect and disease outbreaks, and from human threats such as encroachment, over-utilization, environmental degradation, and excessive development. While managed for environmental needs including watershed protection, protection of rare plant and animal communities, and maintenance of plant and animal diversity, these same resources must also be managed and provide for sociological needs, including provisions for recreational opportunities and the production of raw materials for wood-using industries.

Management must balance local needs with broader state, national, and global concerns through the integration of sound forestry, wildlife, fisheries, endangered resources, water quality, soil, and recreational practices. Management will provide a variety of products and amenities for the future through the use of sustainable forest management practices.



## RUSK COUNTY FOREST

The Rusk County Forest is 89,997 acres in size and includes acreage in twelve townships throughout the county. The following list shows the acreage of forest land by its type classification (total acres will increase when recon is completed on the new county forest law entries from 2024):

Forest Type	Forest Type Description	Stands	Acres	Percent of Forested Acres
A	ASPEN	462	22,434	28%
C	WHITE CEDAR	4	36	0%
FB	BALSAM FIR	1	6	0%
H	HEMLOCK	7	158	0%
MR	RED MAPLE	12	552	1%
NH	NORTHERN HARDWOODS	549	38,173	48%
O	OAK	163	11,890	15%
PR	RED PINE	27	331	0%
PW	WHITE PINE	9	692	1%
SB	BLACK SPRUCE	17	914	1%
SH	SWAMP HARDWOODS	90	2,410	3%
SW	WHITE SPRUCE	19	192	0%
T	TAMARACK	43	1,020	1%
<b>Total:</b>		<b>1,403</b>	<b>78,808</b>	<b>98%</b>

Non-Forest Type Acreage					
Type	Type Description	Stands	Acres	Percent of Non-Forested Acres	Percent of Recon Acres
BK	BRACKEN GRASSLANDS	1	21	0%	0%
CSG	COOL SEASON GRASS	8	30	0%	0%
EW	EMERGENT WETLAND	4	197	2%	0%
G	UPLAND GRASS - *OLD CODE, RECODE	11	45	0%	0%
GG	TRUE GRASSES - *OLD CODE, RECODE	14	80	1%	0%
GH	HERBACEOUS VEGETATION - *OLD CODE, RECODE	5	31	0%	0%
IA	PARKING AREA	2	2	0%	0%
K	MARSH - *OLD CODE, RECODE	31	1,187	12%	1%
KB	MUSKEG - BOG	12	303	3%	0%
KEV	EMERGENT VEGETATION - *OLD CODE, RECODE	6	129	1%	0%
KG	LOWLAND GRASS - *OLD CODE, RECODE	10	306	3%	0%
L	WATER	5	542	6%	1%
LB	LOWLAND BRUSH - *OLD CODE, RECODE	49	1,215	13%	1%
LBA	LOWLAND BRUSH - ALDER - *OLD CODE, RECODE	41	3,078	32%	3%
LM	MINOR LAKE	53	1,139	12%	1%
LMS	MINOR STREAM	2	74	1%	0%
R	RECREATIONAL	1	16	0%	0%
ROW	RIGHT OF WAY	70	639	7%	1%
UB	UPLAND BRUSH - *OLD CODE, RECODE	18	148	2%	0%
WSA	WETLAND SHRUB - ALDER	4	359	4%	0%
Z	ROCK OUTCROPS	4	21	0%	0%
<b>Total:</b>		<b>351</b>	<b>9,562</b>	<b>99%</b>	<b>8%</b>

\*Percentages may not sum to 100% due to rounding



The following list shows current and future anticipated forest stand conditions:

<b>Forest Structure - Past, Present, Future</b>			
<b>Timber Text</b>	<b>Acres Past (1977)</b>	<b>Acres Present (2024)</b>	<b>Acres Future</b>
ASPEN	27,627	22,434	22,790
BALSAM FIR	0	6	9
BLACK SPRUCE	826	914	914
FIR SPRUCE - *OLD CODE, RECODE	1,181	0	0
HEMLOCK	173	158	158
NORTHERN HARDWOODS	37,379	38,173	43,140
OAK	3,814	11,890	7,366
RED MAPLE	0	552	95
RED PINE	838	331	302
SWAMP CONIFER-*OLD CODE, RECODE	26	0	0
SWAMP HARDWOODS	2,521	2,410	2,341
TAMARACK	822	1,020	1,020
WHITE BIRCH	1,080	0	0
WHITE CEDAR	95	36	33
WHITE PINE	0	692	590
WHITE SPRUCE	0	192	82
<b>Total :</b>	<b>76,382</b>	<b>78,808</b>	<b>78,840</b>
BRACKEN GRASSLANDS	0	21	0
COOL SEASON GRASS	0	30	0
EMERGENT VEGETATION - *OLD CODE, RECODE	0	129	129
EMERGENT WETLAND	0	197	0
HERBACEOUS VEGETATION - *OLD CODE, RECODE	189	31	31
LOWLAND BRUSH - *OLD CODE, RECODE	1,179	1,215	1,215
LOWLAND BRUSH - ALDER - *OLD CODE, RECODE	3,278	3,078	3,078
LOWLAND GRASS - *OLD CODE, RECODE	0	306	306
MARSH - *OLD CODE, RECODE	3,094	1,187	1,187
MINOR LAKE	0	1,139	1,120
MINOR STREAM	0	74	0
MUSKEG - BOG	0	303	212
PARKING AREA	0	2	2
RECREATIONAL	0	16	16
RIGHT OF WAY	0	639	582
ROCK OUTCROPS	0	21	21
TRUE GRASSES - *OLD CODE, RECODE	746	80	72
UPLAND BRUSH - *OLD CODE, RECODE	1,285	148	124
UPLAND GRASS - *OLD CODE, RECODE	147	45	45
WATER	0	542	521
WETLAND SHRUB - ALDER	0	359	117
<b>Total :</b>	<b>9,918</b>	<b>9,562</b>	<b>8,778</b>

### **TIMBER SALE ADMINISTRATION**

Timber sale administration is a vital part of effective forest management. The Forestry Department is responsible for the establishment, sale, contract compliance, closeout, and all record keeping on County Forest timber sales. Most RCF sales are sold as combination mill scale for pulp products and woods scale for logs. We will continue to operate the RCF with a full-time Forest Administrator, an Assistant Forest Administrator, two Foresters, a Parks Manager, a Forest Technician, and an Office Manager.

## ANNUAL DNR TIME STANDARDS

Each year, the WI-DNR provides Rusk County a certain number of technical assistance hours to use on the County Forest. Every five years, these ‘time standards’ are set and then become the minimum hours the DNR will provide the County during each DNR fiscal year (July 1-June 30). The Forest Administrator meets with various DNR staff during the Annual Integrated Planning Meeting and part of the discussion revolves around the availability of DNR staff and resources for the upcoming year. Currently, the DNR provides a minimum of 2129 hours per year of assistance which represents a small decline from previous revisions. Historically, the DNR has met or exceeded the ‘time standards’ each year. These hours are needed by Rusk County to address the ever-increasing workload on the County Forest.

## TIMBER SALE PLANNING AND ESTABLISHMENT

Timber harvests that are properly designed and implemented are vital to maintaining a healthy and vigorous forest. There are many social, environmental, and economic benefits derived from a managed harvest program.

Professional implementation of proper forest management and harvest techniques is essential. The timber harvest goal is to produce a sustained yield of forest products using harvest techniques that are suited to the regeneration and growth needs of each forest type. The goal is to develop a regulated harvest in which the same number of acres or the same volume of wood could be harvested each year in perpetuity. Compartment reconnaissance information will be used as a guide to determine stands where timber harvests are needed.

The goal for 2025 will be to establish and market the following number of acres per timber type. These acreage goals are based on the long-term average harvest and will vary from year to year. These acreage goals do not include salvage sales that may occur due to unforeseen circumstances such as insect and disease outbreaks, weather phenomena, and wildland fires.

Long Term Harvest Goals		
Forest Type	15 Year Total (acres)	15 Year Average (acres)
ASPEN	8,869	591
BALSAM FIR	6	0
HEMLOCK	59	4
RED MAPLE	335	22
NORTHERN HARDWOODS	27,926	1,862
OAK	7,078	472
RED PINE	230	15
WHITE PINE	168	11
BLACK SPRUCE	822	55
SWAMP HARDWOODS	1,379	92
WHITE SPRUCE	38	3
TAMARACK	632	42
<b>Total:</b>	<b>47,542</b>	<b>3,169</b>

Information about specific timber sale establishment plans may be obtained by contacting the Rusk County Forestry Department directly.

## FOREST RECONNAISSANCE

The goal for the RCF is to have all recon less than 20 years old and to complete recon for new county forest law entries. Currently, 99.81% of all forest reconnaissance is less than 20 years old in the County Forest. Forest reconnaissance is done following the completion of a timber sale and when a stand is physically entered and subsequently re-scheduled for a later harvest date.

WisFIRS Property Name	RECON Status														
	Acres of Recon by age and % of Total Acres*														
	Total Acres	Forested Acres	< 5 years		5-10 years		11-15 years		16-20 years		21-30 years		>30 years		
		(acres)	(%)	(acres)	(%)	(acres)	(%)	(acres)	(%)	(acres)	(%)	(acres)	(%)	(acres)	(%)
RUSK COUNTY FOREST	88,370	78,808	34,118	38.61	17,236	19.50	28,016	31.70	8,696	9.84	164	0.19	0	0.00	
<b>Total:</b>	<b>88,370</b>	<b>78,808</b>	<b>34,118</b>	<b>38.61</b>	<b>17,236</b>	<b>19.5</b>	<b>28,016</b>	<b>31.7</b>	<b>8,696</b>	<b>9.84</b>	<b>164</b>	<b>0.19</b>	<b>0</b>	<b>0</b>	

## FOREST PROTECTION

Rusk County Forestry Department will continue to cooperate with the WI-Department of Natural Resources:

1. Continue annual meetings to evaluate County Forest operations
2. Support fire suppression efforts when needed
3. Monitor insect, disease and invasive issues, and take appropriate action when necessary



## COUNTY FOREST ROADS

RCF receives state aid money for the maintenance of 23.12 miles of primary roads. These roads are maintained as needed. Plans for 2025 include brushing, grading, culvert replacement, ditching and hauling additional gravel to sustain current traffic levels.

The County Forest has many miles of secondary forest roads that have been built primarily by logging contractors in conjunction with timber sales. These roads are now serving a wide range of uses including the hauling of forest products, snowmobile trails, horse trails, ski trails, ATV/UTV trails, and hunter/walking trails. Some of the

logging roads in environmentally sensitive areas are restricted to motorized use which can lead to erosion, degradation of water quality, and other environmental concerns. These roads are either seeded or allowed to naturally revegetate. Rusk County will continue to protect sensitive areas and address the systemic degradation of water resources as identified by the DNR by managing off-road vehicle use through the newly created Public Trails Ad-Hoc Committee and the Forestry Committee.

## **LAND ACQUISITION**

Lands within the County Forest boundaries or areas of special or unique values may be recommended to the County Board for acquisition as they become available and upon a determination by the County Forest Administrator and the Land & Forestry Committee that ownership of those lands would be beneficial to the citizens of Rusk County. Land Acquisition Funds, and/or State Stewardship Funds will be used.

## **SURVEYING**

We will continue our property line maintenance and establishment. Surveys are generally needed to prevent trespass, eliminate encroachments, or clarify boundaries in order to continue forest management activities.

## **PARKS AND RECREATION**

Snowmobile trails will be maintained by the local snowmobile clubs. The administration of the **318.7** mile snowmobile program will be done by the Forestry Department.

The existing **32.0** miles of ATV/UTV trails will be maintained through ATV clubs with oversight and administration of this program from the Forestry Department. Funding has been secured to develop an additional **12+** miles of ATV/UTV trail in the Blue Hills. The Weirgor project is 5.4 miles and 3 Lakes project is 7.4 miles. Construction on these projects is currently underway and will continue as planned.

The Forest Technician and Parks Manager with the assistance of the summer interns will be used to maintain the over twenty public lake accesses. Some cost-sharing State Funds may be available for the repair of existing boat landings.

Continued improvements in all campgrounds will be conducted by the Parks Manager, Forest Technician, and summer interns. The County will also continue to fund the Conservation Patrol Officer position.

Improvements within our parks, campgrounds, and recreation areas will be explored as opportunities arise. Currently, the Rusk County Forest supports organized ATV/UTV, snowmobile, skiing, snowshoeing, and hiking trails (including the nationally designated Ice Age Trail).

## **WILDLIFE HABITAT PROJECTS**

Rusk County Forest will continue to develop and implement projects in cooperation with WI-DNR wildlife personnel. 15+ miles of game trails will be mowed and approximately 40 acres of wildlife openings will be maintained.



## MISCELLANEOUS

- A. Issue firewood cutting and miscellaneous gathering permits.
- B. Respond to public inquiries and issues as they arise.
- C. Increase signage in the Forest to identify boundaries, roads/access, and natural features.
- D. Provide education classes for students and adults and work with other departments for natural resource education opportunities.
- E. Attend all Wisconsin County Forest Association meetings and continue technical training sessions to aid in the management of the County Forest.
- F. Forest Certification: Rusk County will continue its commitment to remain compliant with Sustainable Forestry Initiative (SFI) certification standards, including making changes as necessary to comply with corrective action requirements.
- G. Investigate and address easement, land trade requests, and encroachments as they arise.
- H. Carbon Credits: Rusk County will continue its involvement with the American Carbon Registry.



## GRANTS & FUNDING

### **County Forest Administration Grant**

Rusk County receives this grant annually. The grant pays 50% of the administrator's salary and up to 50% of benefits so long as benefits don't exceed 40% of the salary.

### **Wildlife Habitat Grant**

Rusk County receives this grant annually. The grant pays roughly \$0.05 per County Forest acre to be used for wildlife habitat development on the County Forest.

### **County Forest Road Aid**

Pays \$351.00 per mile of County Forest Road for maintenance and improvement projects.

### **County Forest Sustainable Forestry Grant**

Funds short-term, unanticipated sustainable forestry projects. Funding is awarded on a competitive basis.

### **Rusk County Funds**

The Forestry Department begins each year with a *negative levy amount*. The department's revenue covers all of its expenses (and more) through timber sales, grant funding, and miscellaneous revenues.

# RUSK COUNTY TIMBER SALE PROSPECTUS – NOTICE OF SEALED BIDS

---

Sealed bids will be accepted by the Rusk County Forestry Committee for the purchase of the designated stumpage on the attached tracts. Bids will be opened on **TUESDAY, NOVEMBER 19<sup>th</sup>, 2024 at 11:00 AM.** in the Law Enforcement Center Meeting Room of the Rusk County Government Center, 311 Miner Ave E, Ladysmith, WI 54848. Bids will not be accepted after 11:00 AM.

## I. BIDDING:

1. Sealed bids are to be marked with the bidder's name and the tract number on the envelope.
2. Bids must be placed separately for each tract.
3. Bid forms must be filled out in their entirety.
4. Bids must be made per ton or per thousand board feet as indicated on the sale prospectus.
5. Bids must meet or exceed the overall minimum bid listed for each sale. Any bid not meeting this requirement will be rejected.
6. Bids must be accompanied by an irrevocable letter of credit, check or cash equal to 10% of the total bid value of the sale.
7. The estimated volume indicated on the timber sale prospectus is no guarantee of that volume. More or less volume may be on the tract and it is the obligation of the bidder to view the tract for purposes of estimating the volume. New bidders and other bidders unfamiliar with Rusk County Timber Sales and Policies should contact the Forest Administrator prior to bidding. An on-site meeting with the successful bidder must occur with a member of Rusk County Forestry (RCF) before any operations can begin. Bidders may use ATVs to view the tract for purposes of determining a potential bid; with the advanced permission of the RCF Administrator.

## II. INSURANCE REQUIREMENTS:

1. Successful bidder must agree to perform all operations under his contract in compliance with Wisconsin's Workman's Compensation Act, Chapter 102, Wisconsin Statutes.
2. The successful bidder must provide Rusk County with a Certificate of Insurance indicating Workers' Compensation coverage is in force for all timber producers on the site or must sign off by the disclaimer in the timber sale contract.
3. A certificate of Comprehensive General Liability Insurance must accompany all bids or be on file in the Rusk County Forestry Office. Rusk County will be listed as a holder of a Certificate before operations begin.

## III. TIMBER SALE CONTRACT AWARDING:

1. The number of Timber Sale Contracts that a timber producer may have will be based on a proven performance record with Rusk County.
2. All new purchasers will be allowed to have only 2 Contracts (Timber Sales) with Rusk County under contract until they have successfully completed (Closed Out) 1 or more contracts.
3. If a new bidder is the highest bidder on more sales than allowed with Rusk County, the County will select which bids will be awarded. The awarding of sales will be done on a basis of the largest price differential between the total highest bid and the next highest bid or zero if no other bids were received. The total bid value of the sale will be used to determine the value of the bid.

## IV. PERFORMANCE DEPOSITS:

1. The **10% Bid Deposit** of successful bidders will be retained as a performance deposit. Bids will be understood to be irrevocable offers for a period of 14 days. Deposits will be returned to unsuccessful bidders. A **Performance Deposit of 25%** of the total bid is required of the successful bidder, who will have 30 days after the bid opening to deposit the additional 15%.
2. The performance deposit may be replaced by an irrevocable letter of credit. Irrevocable letters of credit will be made out until at least **June 30, 2029.**
3. Upon successful completion of the contract, the performance deposits will be returned after the timber sale closing.

## V. LOGGER TRAINING REQUIREMENTS ON RUSK COUNTY TIMBER SALES:

Rusk County requires appropriate training for its logging contractors. Successful purchasers of Rusk County Forest stumpage will need to ensure that the logging purchaser complies with the **Wisconsin Sustainable Forestry Initiative®** Training Standard as adopted by the Wisconsin SFI Implementation Committee (SIC). Criteria for the standard can be found at <http://www.fistausa.org/become-sfi.html>. Documentation confirming completion of the training standard will be required prior to any work on the contract area.

**VI. CONTRACTS AND EXTENSIONS:**

1. Contracts must be signed and returned to the RCF Administrator within 30 days of the bid letting. The 10% performance deposit may be held by the County if a contract is not signed within this time period.
2. No timber sale may begin without a meeting on-site with a member of the RCF Department.
3. Contracts will be issued for a period of 4 years. Contract expiration dates will be listed on each timber sale map.
  - a. **All Tracts EXPIRE December 31, 2028.**
4. Contract Extensions are not guaranteed.
5. If an extension of a Timber Sale Contract is deemed reasonable, the stumpage price agreed upon shall be determined by the Rusk County Forestry Committee.
  - a. **Timber sale contracts for the 2024 Fall opening are 4 years in length.** Extensions may be considered only in extreme circumstances once a contract reaches 4 years of age.
6. All purchasers who have Rusk County Timber Sale Contracts that are 4 years or older, will not be allowed to purchase any additional Rusk County Timber Sales until all current contracts 4 years of age or older are closed out.

**VII. VOLUME STANDARDS/STUMPAGE PAYMENTS:**

1. Rusk County Forestry reserves the right to either accept mill scale or scale wood on the site.
2. All scaled sales will have wood scaled by RCF Department staff or use the County lockbox system prior to wood being removed from the sale.
3. Rusk County will charge 1.5% interest compounded monthly on all past-due timber stumpage bills after 30 days.
4. Saw log merchantability standards are:  
All pine with at least one 100” log to a 9” top, and all hardwood with at least one 100” log to a 10” top.
5. All saw logs will be scaled using Scribner Decimal C. Log Rule.
6. Pulpwood merchantability standards for all species with at least one 100” stick to a 4” top.
7. Rusk County will use the Cordwood weight conversion factor table from the WDNR Timber Sale Handbook.

CORDWOOD WEIGHT CONVERSION FACTORS  
POUNDS PER CORD

Species	Weight (lbs.)	Weight (tons)
Ash	4600	2.300
Aspen	4500	2.250
Balsam	4250	2.125
Balsam poplar	4900	2.450
Basswood	3850	1.925
Beech	5050	2.525
Black Cherry	4300	2.150
Cedar	3150	1.575
Cottonwood	4650	2.325
Elm	5000	2.500
Hard maple	5100	2.550
Hemlock	4800	2.400
Hickory	5400	2.700
Jack pine	4250	2.125
Locust	5300	2.650
Mixed hardwood	4800	2.400
Red oak	5500	2.750
Red pine	4500	2.250
Soft maple	4550	2.275
Spruce	4000	2.000
Tamarack	4650	2.325
White birch	4800	2.400
White oak	5850	2.925
White pine	4200	2.100
Yellow birch	5350	2.675



### VIII. SAWLOG/BOLT WOOD SCALE AND PULPWOOD TICKET SYSTEM REQUIREMENTS:

Removal of wood from the sale area without being scaled by RCF Personnel or without the correct use of the County lockbox system is deemed as harvested without the owner's consent or permission and subjects the Purchaser to civil and/or criminal penalties provided for under sections 26.03, 26.06 and 943.20 of Wis. Statutes. Such unauthorized removal of forest products shall cause cancellation of this contract and forfeiture of the performance bond or deposit and all monies paid to the County. Purchaser agrees to pay double the stumpage rate as indicated in Clause 9 of the contract, as liquidated damages, for such removed timber.

#### **SAWLOG/BOLT WOOD SCALE**

1. All scaled loads of saw logs or bolts will have the appropriate ticket stub deposited in the lockbox prior to leaving the sale area.
2. All saw logs and bolts shall be separated from pulpwood when piled. All saw logs and bolts will be yarded for scaling. If logs are decked, small ends of logs shall be piled all one way, and the log length shall be marked on the small end with a lumber crayon. Decks shall be no higher than 6 feet. At least 5 MBF (thousand board feet) of sawlogs will be skidded and yarded before a scale is requested. All logs and bolts shall be scaled and painted prior to leaving the premises.
3. All pieces which scale 30 board feet or more, net Scribner Scale, and are 50% or more sound must be paid for at the MBF rate. Pieces that scale less than 30 board feet and pieces less than 50% sound must be paid for at the cord rate.
4. After scaling, or, in the event of multiple scaling under this contract, after each scaling, payments for all timber scaled shall be made to the Forestry Administrator at the office of the RCF Department, Rusk County Government Center, Ladysmith, WI within 30 days of billing. There shall be no exceptions to this requirement, and time is of the essence as to all payments required under this contract.

#### **PULPWOOD MILL SCALE**

1. Ticket books shall be issued by the RCF Department as needed. Advance payment of 25% of the sale value will be required before the sale begins.
2. Lockboxes shall be placed on the premises by the RCF Department.
3. The Purchaser shall provide the RCF Department with a list of all destinations of timber to be removed from the premises; changes in timber destination shall be reported before hauling to the new destination.
4. Prior to hauling any timber, the Purchaser agrees to provide, on forms supplied by the RCF Department, the intent of all buyers of cut timber from the premises to return copies of scale slips attached to corresponding tickets. Purchaser agrees to sell no cut timber to any buyer who has not provided written verification of his/her intent to return scale slips and tickets.
5. Each time a load of cut timber leaves the sale area, the appropriate portion of the ticket shall be clearly filled out and deposited in the lockbox.
6. Failure to deposit tickets in the lockbox each time a load of cut timber leaves the sale area will constitute termination of the timber sale contract. Purchaser agrees to pay double the stumpage rate as indicated in clause 9 of the contract, as liquidated damages, for such removed timber.
7. Tickets are issued for the Contract specified on the cover of the ticket book and shall not be used for any other contract.
8. When transporting timber from the sale area, the truck driver shall have in their possession the appropriate portion of the ticket applicable to the load.
9. A list of all truckers that will be hauling wood from the premises shall be provided to the RCF Department by the Purchaser. It shall be the responsibility of the Purchaser to provide such truckers with appropriate ticket books.
10. The RCF Department may check scale and scale tickets at any time.
11. Truck Delivery: The appropriate portion of the ticket shall be detached at the point where the wood is scaled and attached to a duplicate copy of the scale slip. Both shall be returned to the RCF Department.
12. Rail Car Shipment to a Mill: The appropriate portion of the ticket shall be attached to the bill of lading for the car. At the mill, the ticket shall be attached to a copy of the scale slip, then immediately returned to the RCF Department.

### IX. ACCESS AND ROADS:

1. All new construction must be approved by RCF Administrator before construction. The RCF Office must be notified at least 5 working days before road construction.
2. Before closing sales, the purchaser will be responsible for replacing existing soil berms and other obstacles as approved by RCF. Purchasers are also responsible for reclaiming or berming new roads as designated on the sale map.
3. Purchaser is responsible for securing access across any lands not owned by the County prior to bidding.
4. Navigable stream crossings must comply with all federal, state, and local regulations. All necessary water crossing permits will be the responsibility of the RCF Office after written notice of need is provided by the purchaser.

5. No skidding, landing, or piling of wood products will take place on funded ATV Trails, town, county, state, or county forest roads, or on the cleared right of way of same, without written permission from the agency responsible for the said road. Written permission must be on file in the RCF Office.
6. Snowmobile trails are not to be used as access unless permitted in the prospectus. Where permitted, the trails must be maintained with snow cover and be kept free of all logging debris.
7. Wildlife openings may be used for landings provided that the topsoil is not disturbed and remain free of all logging debris at the close of the sale. Other restrictions may be listed on the sale map.
8. Road damage to existing access, roads, or county forest roads, due to logging, will require purchaser repair.
9. Road approaches to surfaced roads or other governmental public roads are the responsibility of the purchaser. Damage to these roads is the responsibility of the purchaser.

X. **RESTRICTIONS:**

1. Sales listed as winter logging are limited to frozen ground operations between December 1 and March 15. Logging before or after these dates is allowed only with prior permission from the RCF Department.
2. Special considerations including Oak Wilt may apply and will be listed on individual sale maps.
3. The use of continuously rotating saw heads (i.e. hot saws) may be prohibited as noted on individual sale maps.

XI. **RUSK COUNTY FORESTRY BEST MANAGEMENT PRACTICES:**

1. Wisconsin Forestry Best Management Practices (BMPs) for Water Quality will be followed. Rutting and other excessive soil damage will result in ceasing operations.
2. RCF Department may change, suspend or terminate any timber sale contract with no penalties to the county if any of the following occur:
  - a. Errors in timber sale planning or design cause or may cause serious environmental damage or violate any county, state, or federal law or regulation.
  - b. Any Forest Health issues arise that may cause serious damage to the Rusk County Forest.
3. More detailed information is available at the RCF Office concerning what is expected of purchasers operating on an RCF Timber Sale.

XII. **RUSK COUNTY FOREST RUTTING POLICY:**

1. The County’s goals for the management of soil disturbances are to:
  - a. Minimize inadvertent soil disturbances and potential adverse impacts on soil productivity, water quality, fish and wildlife habitat, and other natural resources.
  - b. Maintain roads and related structures to intended design standards.
  - c. Combine professional-level expertise and operator experience in the formation of on-the-ground decisions.
  - d. Provide a protocol for identifying and responding to maintenance needs.
2. Excessive Soil Disturbance Determinations
  - a. A soil disturbance is “excessive” if it has exceeded the threshold (see Table 1). An area with an excessive soil disturbance requires special attention from a Timber Sale Administrator (if part of a timber sale) or RCF staff (if part of the county forest road system). Excessive soil disturbances require special attention to evaluate the effect of the soil disturbance and to develop repair or mitigation recommendations. Classifying a soil disturbance as “excessive” does not mandate the closing of a timber sale or a forest road; however, actions should be taken, as appropriate, to minimize further soil disturbances.

*Table 1. Thresholds for soil disturbances.*

Timber Sale Infrastructure	Soil disturbances are excessive if:
Roads, Landings, Skid Trails, and General Harvest Area	A gully or rut is 6 inches deep or more and is resulting in channelized flow to a wetland, stream, or lake.
Roads, Landing, and Primary Skid Trails	In a riparian management zone (RMZ) or wetland, a gully or rut is 6 inches deep or more and 100 feet long or more. In an upland area (outside of RMZ), a gully or rut is 10 inches deep or more and 66 feet long or more.
Secondary Skid Trails and General Harvest Area	A gully or rut is 6 inches deep or more and 100 feet long or more.

## Public Forest Lands Handbook

2. Grants are available for two years unless extended.
3. Counties submit accomplishments and summaries of expenditures to the County Forest & Public Lands Specialist to receive final payment. If requested, 50% advance payments are available.
4. References – s. 28.11(5r), Wis. Stats., NR 47.75, Wis. Adm. Code).
5. Questions for consideration:
  - a. Do the amounts in the county's state aid forestry account match the Sustainable Grant spreadsheet provided by the County Forest & Public Lands Specialist?
  - b. Was the grant deposited in the State Aid Forestry Account?
  - c. Were recommendations for statutory provisions in the last audit implemented so as to maintain eligibility for future County Forest Sustainable Grants?

### Wildlife Habitat Grant

1. Responsibility - Verify that the funds are being deposited in a segregated, non-lapsing wildlife habitat account and the balance is no more than the sum of the allocations for the three previous years. Discuss with the local Wildlife Biologist to ensure that funding has been used for the agreed upon projects.
2. This grant provides a \$.05 an-acre grant for wildlife habitat projects on County Forest land. These funds are non-lapsing and can be carried for 3 years. Each year must be viewed individually for carryover. If funds are not spent, they should be returned to the state unless requesting and granted an extension by the County Forest & Public Lands Specialist.
3. Ensure that the funds are being spent. A separate ledger should itemize the grant and the expenditures.
4. Grant projects need to be identified in each County's 15 Year County Forest Comprehensive Land Use Plan. These projects are agreed upon with the local Department wildlife biologist, approved by the County Forest Administrator, and revisited each year at the Annual Partnership / Annual Work Planning Meeting.
5. References – s. 23.09(17m), Wis. Stats, and the Annual Partnership Meeting minutes.
6. Questions for consideration:
  - a. Is the balance of the grant equal to or less than the sum of the allocations from the three previous years (s. 23.09(17m)(h)1, Wis. Stats., interest excluded).
  - b. Are the expenditures being made for projects approved by Department wildlife biologist and County Forest Administrator and included in the County Forest Comprehensive Land Use Plan?
  - c. Do the deposits in the county's segregated account match that provided by the county forest and public lands specialist?
  - d. Are funds being deposited in the segregated, non-lapsing account?
  - e. Is there documentation of discussion and approval for projects in the Annual Partnership/Planning Meeting minutes?

*Note: If lands withdrawn from County Forest include acreage on which \$.05/acre funds were expended, and if those lands are being transferred to a private party, then a reimbursement of funds is due to the Department. The County Forest & Public Lands Specialist will ascertain that at time of withdrawal application. A debit may show up in the account balance for that reason.*

State of Wisconsin  
DEPARTMENT OF NATURAL RESOURCES  
101 S. Webster Street  
Box 7921  
Madison WI 53707-7921

Tony Evers, Governor

Telephone 608-266-2621  
Toll Free 1-888-936-7463  
TTY Access via relay - 711



April 5, 2024

Dear County Forest Administrators:

I am enclosing your 2024 County Forest Wildlife Habitat Improvement Program payment. Please deposit this payment in your non-lapsing Wildlife Management Fund account. If you have questions regarding the grant program, please contact Doug Brown in Forestry at (715) 966-0157.

The 2009-11 budget reduced this program to \$.05/acre, which is the rate upon which this payment is based. A proration occurred this year since the 2,408,528 acres (7/1/2023) of County Forest times \$0.05 exceeds the \$112,200.00 allocated in the budget. I know this payment is a relatively small contribution toward the overall wildlife habitat created on County Forest lands, but by working as partners, we should be able to accomplish even more toward meeting our common goals.

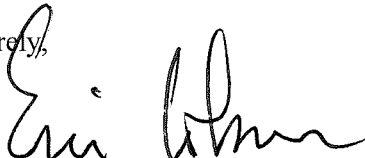
Sincerely,  
  
Eric C Lobner, Director  
Bureau of Wildlife Management

COUNTY OF RUSK  
311 MINER AVE E  
LADYSMITH WI 54848 715-532-2100

Receipt No: 1.133911 Apr 22, 2024

ST OF WI

<b>State of Wisconsin</b>		
Check Date: 3/29/2024	Supplier Number: 000071946	Check No: 1002994140
<b>COUNTY OF RUSK • STATE OF WISCONSIN</b> Ladysmith, WI 54848		18036 4-22-24 \$ 4,158.03
RECEIVED OF	STATE of WI	
FOR	Habitat Improvement Grant	four thousand One hundred fifty eight & 03/100 DOLLARS CHK# 1002994140
ACCOUNT & NAME	100-81-43586-000	

If payment is made by check, this receipt is not valid until check has cleared all banks.

  
COUNTY FOREST ADMINISTRATOR

Report Criteria:

Detail report.

Invoices with totals above \$0 included.

Paid and unpaid invoices included.

Invoice Detail.GL account = "10052"-10054","10060"-10062","204"-206","10024450","1008056114000"-1008056114999","1005955201000"-1005955201999","10081"-10083","10085"-10089"

Invoice Detail.Created date = 10/05/2024-11/11/2024

Vendor Name	Invoice Number	Description	Invoice Date	Net Invoice Amount	GL Account and Title
AMAZON.COM	111-3567636-8	HP COATED PAPER	10/02/2024	74.42	100-61-56111-319 FORESTRY-OFFICE SUPPLIE
AMAZON.COM	111-3984023-7	HP BLACK INK	10/02/2024	67.99	100-61-56111-319 FORESTRY-OFFICE SUPPLIE
AMAZON.COM	111-3984023-7	HP YELLOW INK	10/02/2024	76.99	100-61-56111-319 FORESTRY-OFFICE SUPPLIE
AMAZON.COM	111-3984023-7	(2) 2025 WALL CALENDAR	10/02/2024	22.98	100-61-56111-319 FORESTRY-OFFICE SUPPLIE
AMAZON.COM	111-3984023-7	(2) 2025 WALL CALENDAR	10/02/2024	22.98	100-52-55201-349 PARKS & REC-WORKING SU
AMAZON.COM	111-3984023-7	POST IT NOTES	10/02/2024	6.59	100-61-56111-319 FORESTRY-OFFICE SUPPLIE
AMAZON.COM	111-3984023-7	(2) EXPO DRY ERASE MARKER PACKS	10/02/2024	47.98	100-61-56111-319 FORESTRY-OFFICE SUPPLIE
AMAZON.COM	111-3984023-7	HP CYAN INK	10/02/2024	76.99	100-61-56111-319 FORESTRY-OFFICE SUPPLIE
AMAZON.COM	111-3984023-7	DRY ERASE WALL CALENDAR	10/02/2024	8.99	100-61-56111-319 FORESTRY-OFFICE SUPPLIE
AMAZON.COM	111-3984023-7	2025 PLANNER	10/02/2024	18.78	100-61-56111-319 FORESTRY-OFFICE SUPPLIE
AMAZON.COM	111-3984023-7	GLASS PRIVACY FILM	10/02/2024	89.99	100-61-56111-319 FORESTRY-OFFICE SUPPLIE
AMAZON.COM	111-3984023-7	HP MAGENTA INK	10/02/2024	74.78	100-61-56111-319 FORESTRY-OFFICE SUPPLIE
AMAZON.COM	111-3984023-7	DISCOUNT	10/02/2024	16.85-	100-61-56111-319 FORESTRY-OFFICE SUPPLIE
AMAZON.COM	111-3984023-7	RETURN EXPO MARKER	10/19/2024	23.75-	100-61-56111-319 FORESTRY-OFFICE SUPPLIE
AMAZON.COM	111-9517862-2	BACKRACK HARDWARE RAM	09/04/2024	139.99	100-61-56111-349 FORESTRY-WORKING SUPP
AMAZON.COM	111-9517862-2	BACKRACK HARDWARE F150	09/04/2024	132.30	100-61-56111-349 FORESTRY-WORKING SUPP
AMAZON.COM	111-9517862-2	DISCOUNT	09/04/2024	2.72-	100-61-56111-349 FORESTRY-WORKING SUPP
AMAZON.COM	111-9547866-3	(2) 2025 PLANNERS	10/02/2024	36.42	100-61-56111-319 FORESTRY-OFFICE SUPPLIE
AMAZON.COM	111-9547866-3	(2) 2025 PLANNERS	10/02/2024	36.42	100-52-55201-349 PARKS & REC-WORKING SU
BUCHHOLZ FEED STORE	1722	GRANT ATV 4320 RYE SEED	09/24/2024	66.00	204-62-56122-817 ATV-4320 WEIRGOR TRAIL
ENGEL, DAVID S	2	GRANT ATV4320 TRAIL GRADING	09/20/2024	765.00	204-62-56122-817 ATV-4320 WEIRGOR TRAIL
ENGEL, DAVID S	3	GRANT ATV4320 TRAIL BRUSHING	09/12/2024	3,687.50	204-62-56122-817 ATV-4320 WEIRGOR TRAIL
HOLIDAY INN	20455042	LODGING ORV COUNCIL MTG	08/28/2024	98.00	100-61-56111-339 FORESTRY-CONVENTIONS/
HOLIDAY INN	81095409	LODGING ORV COUNCIL MTG	08/28/2024	98.00	100-61-56111-339 FORESTRY-CONVENTIONS/
JUMP RIVER ELEC COOP INC	17501001 0901	8/01/24-9/01/24 ACCT 17501001 MTHLY CHG	09/05/2024	179.20	100-52-55201-229 PARKS & REC - UTILITIES
JUMP RIVER ELEC COOP INC	17501001 1001	9/01/24-10/01/24 ACCT 17501001 MTHLY CHG	10/05/2024	116.37	100-52-55201-229 PARKS & REC - UTILITIES
JUMP RIVER ELEC COOP INC	17501005 0901	8/01/24-9/01/24 ACCT 175001005 MTHLY CHG	09/05/2024	48.33	100-52-55201-229 PARKS & REC - UTILITIES
JUMP RIVER ELEC COOP INC	17501005 1001	9/01/24-10/01/24 ACCT 17501005 MTHLY CHG	10/05/2024	49.22	100-52-55201-229 PARKS & REC - UTILITIES
JUMP RIVER ELEC COOP INC	17501006 0901	8/01/24-9/01/24 ACCT 175001006 MTHLY CHG	09/05/2024	104.12	100-52-55201-229 PARKS & REC - UTILITIES
JUMP RIVER ELEC COOP INC	17501006 1001	9/01/24-10/01/24 ACCT 17501006 MTHLY CHG	10/05/2024	90.29	100-52-55201-229 PARKS & REC - UTILITIES
JUMP RIVER ELEC COOP INC	17501008 0901	8/01/24-9/01/24 ACCT 17501008 MTHLY CHG	09/05/2024	188.11	100-52-55201-229 PARKS & REC - UTILITIES
JUMP RIVER ELEC COOP INC	17501008 1001	9/01/24-10/01/24 ACCT 175008 MTHLY CHG	10/05/2024	103.16	100-52-55201-229 PARKS & REC - UTILITIES
JUMP RIVER ELEC COOP INC	17501009 0901	8/01/24-9/01/24 ACCT 17501009 MTHLY CHG	09/05/2024	164.36	100-52-55201-229 PARKS & REC - UTILITIES
JUMP RIVER ELEC COOP INC	17501009 1001	9/01/24-10/01/24 ACCT 17501009 MTHLY CHG	10/05/2024	113.49	100-52-55201-229 PARKS & REC - UTILITIES

Vendor Name	Invoice Number	Description	Invoice Date	Net Invoice Amount	GL Account and Title
JUMP RIVER ELEC COOP INC	17501010 0901	8/01/24-9/01/24 ACCT 17501010 MTHLY CHG	09/05/2024	58.78	100-52-55201-229 PARKS & REC - UTILITIES
JUMP RIVER ELEC COOP INC	17501010 1001	9/01/24-10/01/24 ACCT 17501010 MTHLY CHG	10/05/2024	58.78	100-52-55201-249 PARKS & REC-MAINTENANC
KREIER FOREST PRODUCTS LLC	10162024	GRANT CC24-55WM PARKING LOT WORK	10/16/2024	700.00	100-60-56115-000 COUNTY CONSERV AIDS EX
LADYSMITH ACE HARDWARE	J27533/1	(2) 4" BRUSH	07/26/2024	17.98	100-52-55201-349 PARKS & REC-WORKING SU
LADYSMITH ACE HARDWARE	J27533/1	DISCOUNT	07/26/2024	1.00-	100-52-55201-349 PARKS & REC-WORKING SU
LADYSMITH ACE HARDWARE	J32023/1	(2) WASP & HORNET SPRAY	08/06/2024	8.98	100-52-55201-349 PARKS & REC-WORKING SU
LADYSMITH ACE HARDWARE	J32023/1	FLY PAPER	08/06/2024	6.29	100-52-55201-349 PARKS & REC-WORKING SU
LADYSMITH ACE HARDWARE	J32023/1	TRIMMER LINE	08/06/2024	8.99	100-52-55201-249 PARKS & REC-MAINTENANC
LADYSMITH ACE HARDWARE	J32160/1	SCREEN	08/07/2024	13.49	100-52-55201-249 PARKS & REC-MAINTENANC
LADYSMITH ACE HARDWARE	J34543/1	FIBERGLASS TAPE	08/13/2024	31.49	100-61-56111-349 FORESTRY-WORKING SUPP
LADYSMITH ACE HARDWARE	J34543/1	DISP GLOVES	08/13/2024	32.38	100-61-56111-349 FORESTRY-WORKING SUPP
LADYSMITH ACE HARDWARE	J39896/1	30 AMP BREAKER	08/27/2024	8.99	100-52-55201-249 PARKS & REC-MAINTENANC
LADYSMITH ACE HARDWARE	J39896/1	20 AMP BREAKER	08/27/2024	8.99	100-52-55201-249 PARKS & REC-MAINTENANC
LADYSMITH ACE HARDWARE	J39896/1	OULET	08/27/2024	2.67	100-52-55201-249 PARKS & REC-MAINTENANC
LADYSMITH ACE HARDWARE	J40349/1	WASP & HORNET SPRAY	08/28/2024	8.98	100-52-55201-349 PARKS & REC-WORKING SU
LADYSMITH ACE HARDWARE	J40349/1	GFI RECEPTICAL	08/28/2024	48.58	100-52-55201-249 PARKS & REC-MAINTENANC
LADYSMITH ACE HARDWARE	J40349/1	GFCI RECEPTICAL	08/28/2024	48.58	100-52-55201-249 PARKS & REC-MAINTENANC
LADYSMITH ACE HARDWARE	J40504/1	(2) 30 AMP BREAKER	08/29/2024	17.98	100-52-55201-249 PARKS & REC-MAINTENANC
LADYSMITH ACE HARDWARE	J40504/1	OUTLET	08/29/2024	8.99	100-52-55201-249 PARKS & REC-MAINTENANC
LADYSMITH ACE HARDWARE	J42827/1	(2) TIE DOWNS	09/04/2024	48.58	100-61-56111-349 FORESTRY-WORKING SUPP
LADYSMITH ACE HARDWARE	J42827/1	(2) TOILET SEAT COVERS	09/04/2024	25.18	100-52-55201-249 PARKS & REC-MAINTENANC
LADYSMITH ACE HARDWARE	J45684/1	RETURN - KEY MISCUTS	09/11/2024	35.58-	100-61-56111-349 FORESTRY-WORKING SUPP
LADYSMITH ACE HARDWARE	J48454/1	FASTNER - WIRE MESH	09/18/2024	5.00	100-52-55201-249 PARKS & REC-MAINTENANC
LADYSMITH ACE HARDWARE	J48454/1	5/64 BIT	09/18/2024	5.39	100-52-55201-249 PARKS & REC-MAINTENANC
LADYSMITH ACE HARDWARE	J48454/1	7/64 BIT	09/18/2024	7.19	100-52-55201-249 PARKS & REC-MAINTENANC
LADYSMITH ACE HARDWARE	J48454/1	SCREWS	09/18/2024	13.49	100-52-55201-249 PARKS & REC-MAINTENANC
LADYSMITH ACE HARDWARE	J48454/1	PUMP TRANSFER	09/18/2024	161.99	100-52-55201-249 PARKS & REC-MAINTENANC
LADYSMITH ACE HARDWARE	J53039/1	WD40	09/30/2024	8.09	100-61-56111-349 FORESTRY-WORKING SUPP
LADYSMITH ACE HARDWARE	J53039/1	TIE DOWN 16'	09/30/2024	17.99	100-61-56111-349 FORESTRY-WORKING SUPP
LADYSMITH ACE HARDWARE	J54152/1	LEATHER WORK GLOVES	10/03/2024	15.29	100-52-55201-349 PARKS & REC-WORKING SU
LADYSMITH ACE HARDWARE	J55844/1	PESTBLOCK	10/07/2024	10.79	100-52-55201-349 PARKS & REC-WORKING SU
LADYSMITH ACE HARDWARE	J55844/1	GLOVES	10/07/2024	16.19	100-61-56111-349 FORESTRY-WORKING SUPP
LADYSMITH ACE HARDWARE	J59043/1	(36) ANTIFREEZE GALLON	10/15/2024	108.00	100-52-55201-249 PARKS & REC-MAINTENANC
LADYSMITH ACE HARDWARE	J59515/1	WD40	10/16/2024	6.29	100-52-55201-349 PARKS & REC-WORKING SU
LADYSMITH ACE HARDWARE	J59515/1	COUPLE INSERT	10/16/2024	1.61	100-52-55201-249 PARKS & REC-MAINTENANC
LADYSMITH ACE HARDWARE	J59515/1	(2) CLAMP	10/16/2024	5.38	100-52-55201-249 PARKS & REC-MAINTENANC
LADYSMITH ACE HARDWARE	J59515/1	BROOM	10/16/2024	13.49	100-52-55201-349 PARKS & REC-WORKING SU
LADYSMITH ACE HARDWARE	J61441/1	(2) GAL PAINT THINNER	10/22/2024	31.98	100-61-56111-349 FORESTRY-WORKING SUPP
LADYSMITH ACE HARDWARE	J61441/1	LEATHER GLOVES	10/22/2024	15.29	100-61-56111-349 FORESTRY-WORKING SUPP
LADYSMITH ACE HARDWARE	J62426/1	(4) FASTENER	10/23/2024	9.16	100-52-55201-249 PARKS & REC-MAINTENANC
LADYSMITH ACE HARDWARE	J62426/1	(4) FASTENER	10/23/2024	1.68	100-52-55201-249 PARKS & REC-MAINTENANC

Vendor Name	Invoice Number	Description	Invoice Date	Net Invoice Amount	GL Account and Title
LADYSMITH ACE HARDWARE	J62426/1	(8) FASTENER	10/23/2024	2.08	100-52-55201-249 PARKS & REC-MAINTENANC
LADYSMITH ACE HARDWARE	J62426/1	(4) CHAIN COIL	10/23/2024	14.36	100-52-55201-249 PARKS & REC-MAINTENANC
LADYSMITH ACE HARDWARE	J62426/1	BOLT EYE LAG	10/23/2024	1.79	100-52-55201-249 PARKS & REC-MAINTENANC
LADYSMITH ACE HARDWARE	J62426/1	QUICK LINK CHAIN	10/23/2024	3.59	100-52-55201-249 PARKS & REC-MAINTENANC
LADYSMITH ACE HARDWARE	J62426/1	SPRING SNAP	10/23/2024	2.51	100-52-55201-249 PARKS & REC-MAINTENANC
LADYSMITH ACE HARDWARE	J62426/1	BOLT EYE LAG	10/23/2024	1.79	100-52-55201-249 PARKS & REC-MAINTENANC
LADYSMITH ACE HARDWARE	J62681/1	(3) UBOLTS	10/24/2024	16.17	100-52-55201-249 PARKS & REC-MAINTENANC
LADYSMITH ACE HARDWARE	J62681/1	(3) UBOLTS	10/24/2024	8.07	100-52-55201-249 PARKS & REC-MAINTENANC
LADYSMITH ACE HARDWARE	J692682/1	PUMP TRANSFER RETURN	10/24/2024	161.99-	100-52-55201-249 PARKS & REC-MAINTENANC
LADYSMITH NEWS	19041	GRANT ATV4320 ADVERTISE FOR BID	10/24/2024	147.25	204-62-56122-817 ATV-4320 WEIRGOR TRAIL
LAMPERT LUMBER	13638575	(2) TREATED 6X6X16 (1) TREATED 6X6X8 (3) TREATED 2X6X8 (3	09/05/2024	299.23	100-52-55201-249 PARKS & REC-MAINTENANC
LAMPERT LUMBER	2675157	(20) QUIKRETE	08/12/2024	99.00	100-52-55201-249 PARKS & REC-MAINTENANC
NCP COATINGS	153899	(300) GALLON BARK MARK ORANGE	10/21/2024	5,316.00	100-61-56111-349 FORESTRY-WORKING SUPP
NCP COATINGS	153899	(300) QT BRK MARK ORANGE	10/21/2024	2,382.00	100-61-56111-349 FORESTRY-WORKING SUPP
NCP COATINGS	153899	FREIGHT	10/21/2024	230.94	100-61-56111-349 FORESTRY-WORKING SUPP
PETE'S TRAILER SALES INC	50149	UTILITY TRAILER	08/06/2024	3,375.00	100-61-56111-811 FORESTRY-EQUIPMENT
PETE'S TRAILER SALES INC	50149	SPARE TIRE	08/06/2024	175.00	100-61-56111-811 FORESTRY-EQUIPMENT
PETE'S TRAILER SALES INC	50149	TITLE AND PLATE REGISTRATION	08/06/2024	169.50	100-61-56111-811 FORESTRY-EQUIPMENT
POINT & PAY LLC	9669 10222024	AUGUST 2024 107 CAMPSITE CHARGES	10/22/2024	275.00	100-52-55201-290 PARKS & REC-POINT & PAY
QUALITY INN	942024410	LODGING WCFA FALL MEETING	09/27/2024	196.00	100-61-56111-339 FORESTRY-CONVENTIONS/
QUALITY INN	942024411	LODGING WCFA FALL MEETING	09/27/2024	196.00	100-61-56111-339 FORESTRY-CONVENTIONS/
RASSBACH COMMUNICATIONS	8972	MONTHLY NETWORK REPEATER AUGUST 2024	09/06/2024	125.44	100-61-56111-225 FORESTRY-COMMUNICATIO
RASSBACH COMMUNICATIONS	8972	CALLBOX DISPATCH RADIO	09/06/2024	35.84	100-52-55201-225 PARKS - COMMUNICATIONS
RASSBACH COMMUNICATIONS	9145	MONTHLY NETWORK REPEATER OCTOBER 2024	10/01/2024	125.44	100-61-56111-225 FORESTRY-COMMUNICATIO
RASSBACH COMMUNICATIONS	9145	CALLBOX DISPATCH RADIO	10/01/2024	35.84	100-52-55201-225 PARKS - COMMUNICATIONS
REPUBLIC SERVICES #930	0930-0013682	SEPTEMBER 2024 FORESTRY SHOP	08/25/2024	67.93	100-61-56111-216 FORESTRY- CONTRACT SER
REPUBLIC SERVICES #930	0930-0013682	SEPTEMBER 2024 CAMPGROUNDS	08/25/2024	902.52	100-52-55201-216 PARKS & REC-CONTRACTE
REPUBLIC SERVICES #930	0930-0013682	SEPTEMBER 2024 FUEL RECOVERY FEE	08/25/2024	183.94	100-52-55201-216 PARKS & REC-CONTRACTE
REPUBLIC SERVICES #930	930-00137791	OCTOBER 2024 FORESTRY SHOP	09/25/2024	33.00	100-61-56111-216 FORESTRY- CONTRACT SER
REPUBLIC SERVICES #930	930-00137791	OCTOBER 2024 CAMPGROUNDS	09/25/2024	466.67	100-52-55201-216 PARKS & REC-CONTRACTE
REPUBLIC SERVICES #930	930-00137791	OCTOBER 2024 FUEL RECOVERY FEE	09/25/2024	93.91	100-52-55201-216 PARKS & REC-CONTRACTE
RUSK RIDERS ATV CLUB	10092024	GRANT ATV 5788 MAINTENANCE REIMBURSEMENT	10/09/2024	1,785.00	204-62-56122-366 ATV-TRAIL MAINTENANCE
RUSK RIDERS ATV CLUB	10312024	GRANT ATV 5788 MAINTENANCE REIMBURSEMENT	10/31/2024	7,942.50	204-62-56122-366 ATV-TRAIL MAINTENANCE
RUSS THOMPSON EXCAVATING INC	51019	GRADE FOREST ROAD	10/29/2024	276.00	100-82-56113-366 FOREST RD AID- MAINTENA
TRACTOR CENTRAL	2817557	10W30 OIL	07/31/2024	63.07	100-52-55201-349 PARKS & REC-WORKING SU
TRACTOR CENTRAL	2817557	OIL FILTER	07/31/2024	9.70	100-52-55201-349 PARKS & REC-WORKING SU
TRACTOR CENTRAL	2817557	OIL FILTER	07/31/2024	9.48	100-52-55201-349 PARKS & REC-WORKING SU
TRACTOR CENTRAL	2817557	(6) BLADE	07/31/2024	105.72	100-52-55201-349 PARKS & REC-WORKING SU
TRACTOR CENTRAL	463371	Z930M REPAIRS	09/17/2024	484.78	100-52-55201-249 PARKS & REC-MAINTENANC
TRAILS NORTH POWERSPORTS	013205	50' WINCH ROPE	10/24/2024	72.85	100-52-55201-249 PARKS & REC-MAINTENANC
US DEPT OF AGRICULTURE	3005135973	2024 BEAVER CONTROL, PERSONNEL COMP	10/01/2024	4,099.69	204-61-56121-348 SAFOREST-TIMBER SALE E

Vendor Name	Invoice Number	Description	Invoice Date	Net Invoice Amount	GL Account and Title
US DEPT OF AGRICULTURE	3005135973	2024 BEAVER CONTROL, PROGRAM SUPPORT	10/01/2024	1,113.05	204-61-56121-348 SAFOREST-TIMBER SALE E
VEOLIA	06252024	HAZARD WASTE DISPOSAL	06/25/2024	329.25	100-61-56111-216 FORESTRY- CONTRACT SER
VERIZON WIRELESS	9975542243	10/05/24-11/04/24 ACCT 983216421-00001 MTHLY CHRGS 997554	10/04/2024	45.51	100-61-56111-225 FORESTRY-COMMUNICATIO
WALLY'S SAW & GUN	71717	POLE SAW BAR	08/13/2024	29.99	100-61-56111-349 FORESTRY-WORKING SUPP
WE ENERGIES	5170991893	08/07/24-09/04/24 ACCT 0717772340-00001 MTHLY CHRGS 51669	09/10/2024	9.57	100-61-56111-229 FORESTRY- SHOP/ UTILITIE
WE ENERGIES	5208713873	09/05/24-10/03/24 ACCT 0717772340-0001 MTHLY CHRGS 520359	10/09/2024	9.57	100-61-56111-229 FORESTRY- SHOP/ UTILITIE
WI COUNTY FORESTS ASSOC	2024-112	(3) FALL WCFA MEETING ATTENDANCE	10/15/2024	180.00	100-61-56111-339 FORESTRY-CONVENTIONS/
XCEL ENERGY	894623898	08/01/2024-09/02/2024 ACCT 52-6703448-6 MTHLY CHRGS 11318	09/17/2024	62.96	100-61-56111-229 FORESTRY- SHOP/ UTILITIE
XCEL ENERGY	895372708 092	8/21/24-9/23/24 ACCT 5263578043 MTHLY CHG	09/23/2024	258.59	100-52-55201-229 PARKS & REC - UTILITIES
Grand Totals:				40,051.91	